

SYSTEM 40® ROLLER SYSTEM WITH CRANK HANDLE OPERATION

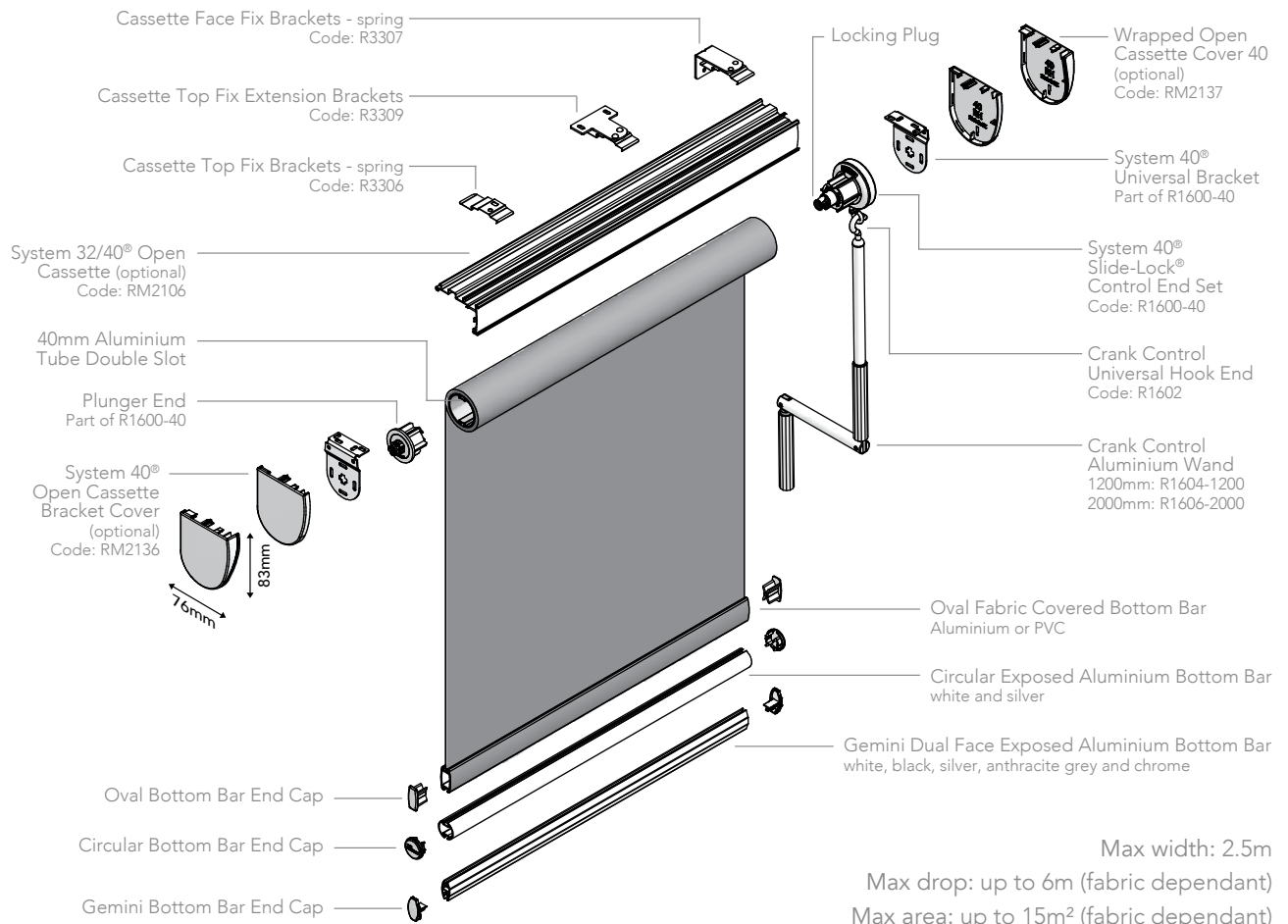

Max width: 2.5m
Max drop: up to 6m (fabric dependant)
Max area: up to 15m² (fabric dependant)

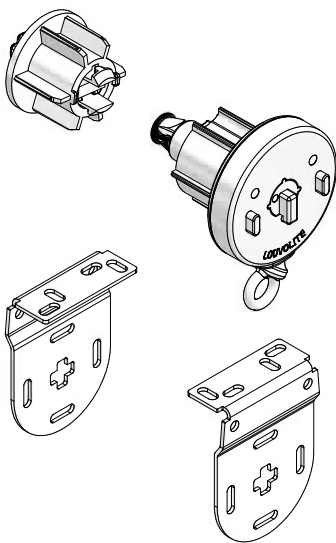

- Designed and manufactured in the UK, all Louvolite systems are 10 year life cycle tested to ensure long lasting performance.
- System 40® Slide-Lock® combines heavier holding weights with anti-fray features that ensure enhanced blind performance.
- For blinds up to 2.5m wide, with a 9lb maximum holding weight.
- Universal brackets and a spring idle end plunger enable easy and quick installation.
- Manufactured using high quality engineering grade polymer.
- Locking plug inside clutch ensures continued performance of larger blinds.
- Crank control aluminium wand available in 1200mm and 2000mm lengths.
- Crank Control can be right or left hand operated.
- Crank control hook fixing ring (R1608) or wall fixing clip (R1612) available for storing when detached.
- Crank control available in white or black.

HARDWARE SPECIFICATION

System 40® with Crank Handle Roller System

Our roller blinds are manufactured using the Louvolite System 40® roller blind mechanism with specifically designed grooved 40mm aluminium tubing. The specified fabrics are formed and held into the tube with locking tape. The side control units are made from glass filled Nylon 6, with an acetal sprocket and sprocket guard, and includes a locking spring.

The crank control hook is made of prime quality plastic and the wand is manufactured using aluminium. The mild steel brackets are zinc plated and powder coated, suitable for top, face or side fixing.

A sprung plunger end mechanism is positioned at the opposite end to the control unit, providing a more secure fit of the blind and smooth operation. The side

control unit is fitted with a centre plug that ensures the mechanism operates smoothly even under extreme loads.

Colour spec: White RAL 9010, Black RAL 9011

Performance

To ensure a positive performance, all Louvolite Roller System units are designed and manufactured in the UK using prime quality plastic materials and a dedicated steel locking spring. The sidewinders will lock into the bracket with the unique bracket securing pin for safety after installation.

10 year life cycle testing is done to ensure long lasting performance.

Operation

The System 40® with Crank Handle operation is child safe by design and therefore complies with BS EN 13120.

Smooth and easy operation with a detachable wand. Has the ability to be operated as either left or right-handed control.

Bottom Bar

Oval, made of aluminium or pvc, can be single or double wrapped in fabric or left exposed, while circular and the dual face Gemini, made of aluminium, only have the fabric formed and locked into the top part to leave the bar exposed. All fabric is formed and held into place with locking tape. The dual face Gemini bar, smooth on one side and angular on the other, improves the ease of manufacture and use of thicker laminate fabrics.

Maintenance

All of the System 40® roller blind system components are manufactured using aluminium, treated steel and

plastic. They do not present any corrosion problems in normal environments. The system has been designed for a smooth operation, together with a rigidity to prolong the window blind's working life. Manufacturing size restrictions are included in this specification brochure.

System 40® Roller Blind System with Crank Handle and Optional Cassette

Roller blinds with cassettes are manufactured as per the standard Louvolite System 40® and include the specially designed powder coated cassette system with dedicated top, direct or face fix brackets. On specification the user has the choice between a single coloured extrusion in dedicated colours or a fascia which incorporates the same fabric or contrasting fabric used on the roller blind.

CRANK HANDLE BRACKET DIMENSIONS

- A. 40® crank handle standard metal bracket top fix & cover
- B. 40® crank handle standard metal bracket top fix front view

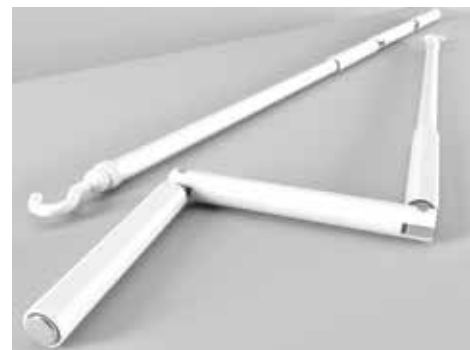
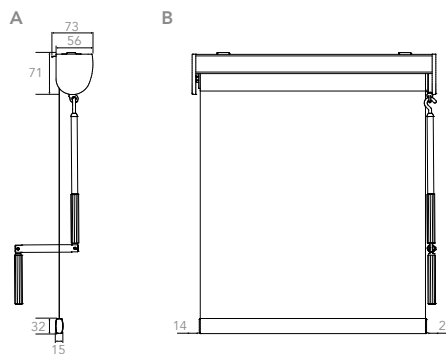

LOUVOLITE SIDE CONTROL SYSTEMS MAXIMUM BLIND SIZE

SYSTEM	FABRIC GROUP	BLIND WIDTH (m) FOR BLIND DROP (m)					MAX HOLDING WEIGHT
		0.5	1.0	1.5	2.0	2.5	
System 40®	up to 200g/m sq 200 > 320g/m sq 320 > 485g/m sq	5.0 3.75 5.0	5.0 3.75 5.0	5.0 3.75 5.0	5.0 3.75 3.55	5.0 3.75 2.7	9lb blind at 6mm deflection

Your Louvolite System 40® Crank Handle Distributor:



UK MANUFACTURED

www.louvolitecommercial.com

CI/SIB 1976 reference by SIB Agency		
(76.7)	X	

S250102-40-CH 07.19